



**File Name:** bunn vp17 2 sst manual.pdf

**Size:** 4987 KB

**Type:** PDF, ePub, eBook

**Category:** Book

**Uploaded:** 6 May 2019, 19:38 PM

**Rating:** 4.6/5 from 644 votes.

**Status:** AVAILABLE

Last checked: 18 Minutes ago!

**In order to read or download bunn vp17 2 sst manual ebook, you need to create a FREE account.**

[\*\*Download Now!\*\*](#)

eBook includes PDF, ePub and Kindle version

[Register a free 1 month Trial Account.](#)

[Download as many books as you like \(Personal use\)](#)

[Cancel the membership at any time if not satisfied.](#)

[Join Over 80000 Happy Readers](#)

### Book Descriptions:

We have made it easy for you to find a PDF Ebooks without any digging. And by having access to our ebooks online or by storing it on your computer, you have convenient answers with bunn vp17 2 sst manual . To get started finding bunn vp17 2 sst manual , you are right to find our website which has a comprehensive collection of manuals listed.

Our library is the biggest of these that have literally hundreds of thousands of different products represented.



## Book Descriptions:

# bunn vp17 2 sst manual



Contact BunnOMatic Corporation at 18002866070 to obtain a paper copy of the required Illustrated Parts Catalog mailed via U.S. Postal Service. The brewer has an attached cordset and requires 2wire grounded service rated 120 volts ac, 15 amp, single phase, 60 Hz. A sixhole stainless steel spray head must be used for proper extraction. Refer to Troubleshooting for assistance in determining the cause of any problem. WARNING Inspection, testing, and repair of electrical equipment should be performed only by qualified service personnel. Test Procedures 1. Disconnect the brewer from the power source. 2. With a voltmeter, check the voltage across the blue wire on the control thermostat and the white wire on the tank heater. Test Procedures 1. Disconnect the brewer from the power source. 2. Disconnect the blue and black wires from the limit thermostat. Test Procedures 1. Disconnect the brewer from the power supply. 2. With a voltmeter, check the voltage across the black and white wires on the tank heater. On VP17B Models the tank heater switch is located on left side of the control panel. Refer to Limit Thermostat, Tank Heater and Control Thermostat sections in this manual when reconnecting wires. Related Products Paper Filter Pack. Bunn Corporation owns all copyrights relating to materials in this publication. Please contact Bunn Corporation to request permission to reproduce any portion of this publication. You should have JavaScript enabled in your browser to utilize the functionality of the website Parts Town and 3Wire have joined forces and teamed up with IPC, combining the team you know with the largest inventory in the industry and cuttingedge technology to give you the absolute best experience. Things look a little different, that's true, but you are indeed in the right place. Hi there, welcome to Parts Town. <http://aquafilling.com/userfiles/delete-trojan-virus-manually.xml>

- **bunn vp17-2 sst manual, bunn vp17 2 sst manual, bunn vp17 2 sst manual pdf, bunn vp17 2 sst manual download, bunn vp17 2 sst manual instructions, bunn vp17 2 sst manual 1.**



Parts Town and 3Wire have joined forces and teamed up with NDCP, combining the team you know with the largest inventory in the industry and cuttingedge technology to give you the absolute best experience. Parts Town and 3Wire have joined forces and teamed up with SMS, combining the team you know with the largest inventory in the industry and cuttingedge technology to give you the absolute best experience. Hi there! RSCS and Parts Town have joined forces, combining the team you know with the largest inventory in the industry and cuttingedge technology to give you the absolute best experience. Parts Town and 3Wire Foodservice have joined forces. Now youll work with the great team you know, while having access to the largest inventory in the industry and cuttingedge technology. Lets go! Continue to Parts Town What You Can Expect Always Genuine OEM The Most InStock Parts on the Planet Breakthrough Innovations Exceptional Customer Experience Same Day Shipping Ready to get started. Lets go! Continue to Parts Town Looking for beverage equipment parts. Marmon Link is the new home for genuine OEM parts for the Marmon family of equipment manufacturers. Find beverage dispense parts and accessories, as well as parts for Cornelius, Prince Castle, Silver King, Angelo Po, and Saber King units. Continue to Marmon Link Please try again. Please try again later. Please try again later. No worries, it's really easy. No need to remember another username, you will now use your email address. Its listed below. Once logged in you can view pricing and order these parts. OK Please try again. Always Available free backorder shipping applies to UPS Ground shipments only. Excludes international orders, UPS Freight orders, consolidated shipments, factory drop ship orders, and ship complete orders. Program details subject to change at any time. No need to type it all again. That just makes things WAY easier.[https://cyklokram.com/static\\_pages\\_files/delete-ukash-manually.xml](https://cyklokram.com/static_pages_files/delete-ukash-manually.xml)



Plus, you'll be able to access any discounts or contract pricing that may be available to you. That's important. The real question is, why wouldn't you log in? Everybody loves cookies. Okay, they're not those kind of cookies, but they're still great. For more information, go to [www.p65warnings.ca.gov](http://www.p65warnings.ca.gov). Please try refreshing the page, or contact us at 800 6262866 if the problem continues. Your selected catalog region indicates that you are outside the U.S. Please change your region to North America U.S. if you wish to check out. For international orders please call us at 1 217 529 6601. Page Count 2 Low Profile Pour-over Coffee Brewer Dimensions 18.9" H x 8.5" W x 17.8" D For current specification sheets and other information, go to [www.bunn.com](http://www.bunn.com). Related Products. Paper Filter Pack. Product No. 20115.0000. Packed per case 1,000 WX1 warmer. Product No. 06450.0004. One position warmer. Product No. 06100.0101. Quantity 1 also packaged in. WX2 warmer. Product No. 06310.0004. Two position warmer. Product No. 06101.0101. Model. Agency Listing Amps. Tank Heater. Watts. Total. Brewing. Capacity. Cu. Ft. Shipping. Weight. Cord. Attached Electrical Models require 2 wires plus ground service rated 120V, single phase, 60 Hz. Plumbing No plumbing needed. All dimensions shown in inches. Bunn Corporation owns all copyrights relating to materials in this publication. Please contact Bunn Corporation to request permission to reproduce any portion of this publication. File Type Extension pdf. PDF Version 1.3. Linearized Yes. Page Count 2. XMP Toolkit XMP toolkit 2.9.113, framework 1.6. About uuid4dd85250d0a211db8ce60016cb372530. Create Date 20060401 150321Z. Modify Date 20070312 0902240500. Metadata Date 20070312 0902240500. Creator Tool Adobe InDesign CS 3.0.1. Version ID 1. Rendition Class proofpdf. Document ID adobedocidindd966b10e7c32211dab95e93f0117c43ac. Derived From Instance ID 966b10e6c32211dab95e93f0117c43ac. Derived From Document ID adobedocidinddb0e36b72ac9c11d894c599b2c6087c99.

Derived From Version ID 1. Manifest Link Form ReferenceStream, ReferenceStream, ReferenceStream, ReferenceStream, ReferenceStream. Title A54.indd. Trapped False. Creator Adobe InDesign CS 3.0.1. Producer Adobe PDF Library 6.0. Highest quality workmanship and materials throughout for long dependable life. Separately controlled warmer. They exclude delivery charges and customs duties and do not include additional charges for installation or activation options. Prices are indicative only and may vary by country, with changes to the cost of raw materials and exchange rates. Accepts thermal carafe up to 8.5" 21.6 cm tall. All stainless steel construction. Hot water faucet. Pour-over feature. Please choose a different delivery location. Our payment security system encrypts your information during transmission. We don't share your credit card details with thirdparty sellers, and we don't sell your information to others. Please try again. Please try again. Show details. Ships from and sold by KaTom Restaurant Supply, Inc. Sold by Super Choice A TO Z and ships from Amazon Fulfillment. Register a free business account Please try

your search again later. Unique spray head ensures even, complete coffee flavor extraction. Stainless steel internal hot water tank keeps water heated to optimal brewing temperature of 200 Degree F. For more information go to [www.P65Warnings.ca.gov](http://www.P65Warnings.ca.gov). To calculate the overall star rating and percentage breakdown by star, we don't use a simple average. Instead, our system considers things like how recent a review is and if the reviewer bought the item on Amazon. It also analyzes reviews to verify trustworthiness. Please try again later. Tim M. 4.0 out of 5 stars Then I read this reply to another customer complaint. I found it super helpful. There is a temp probe that dangles inside the hot water tank. It is connected by very thin wire. This probe was touching the sides of the hot water tank inside. Once I adjusted it I had really hot coffee.

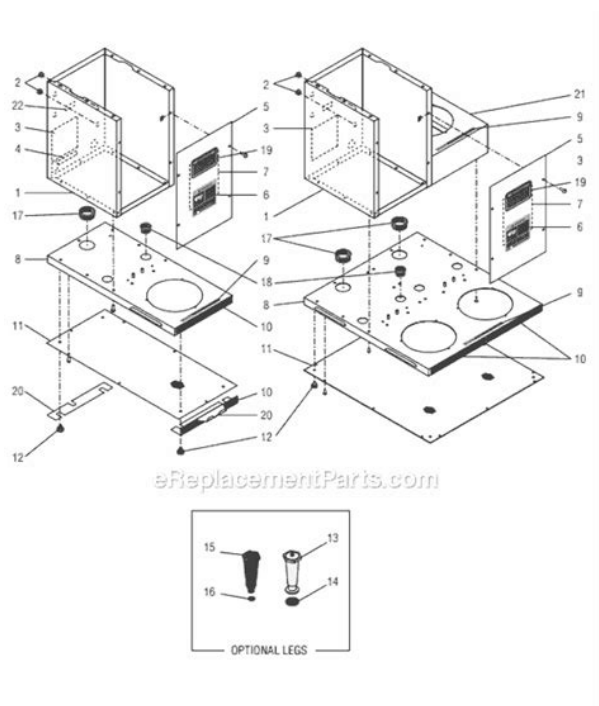

<http://www.drupalitalia.org/node/76620>

This should be an automatic check for anyone who has one of these shipped because there will be a high probability of this probe touching the sides. This is used to keep the water hot after the main element brings the water up to the set brewing temperature of 200 degrees as the Bunn service manual states. The main heating element is the one that affects the VP17s max brew level and this one is adjustable, but you need to verify that the water is at 200 degrees first. The water fill lid can now be lifted up and removed by sliding it back and off. You will now see a stainless steel slopping fill pan with a drain leading directly into the stainless steel water heating pot. To check the water temperature you will need a Taylor Classic InstantRead Pocket Thermometer sold here at Amazon and supply stores. Insert the stem of the thermometer into the hot water pot fill hole. Turning the knob clockwise will increase the water temperature and counter clockwise will decrease it. If the thermostat is at its max setting and will not increase the water temperature to 200 degrees, make sure the adjustable VP17s thermostats sensing bulb that runs into the VP17s water heater pot is NOT touching the sides of the pot this will make it read a false high. If it is not touching the pot sides, be sure it is near the bottom of the water pot about an inch from the bottom. To do this, the fill pan must be removed. If this is correct, then the VP17s thermostat itself is bad and a new must be ordered from a Bunn part house. I love my Bunn VP17 and use it twice a day. It is a high quality unit built of stainless steel to last a life time! According to my filter order history, I've brewed over 5,000 pots of coffee thus far. This is my favorite small appliance by far and if it ever broke which I doubt it ever will I will immediately order another one. I also ordered the pack of 1,000 filters and a couple

Bunn coffee pots.

<http://aplusresidentialcleaning.com/images/bosu-balance-trainer-instruction-manual.pdf>

**BUNN**



I cant say enough good about this thing, which makes a great pot of coffee in less than 3 minutes!It works great.Sorry, we failed to record your vote. Please try again In order to navigate out of this carousel please use your heading shortcut key to navigate to the next or previous heading. Shop Online and Parts Ship Today. Call us at 1800 4585593 Call 8004585593 Not to worry, partstown.com is ready to help. Please place this order and all future international orders there. Click here for detailed listing. Halifax, NS B3K 1X2 9024547461 Consistently brews perfect coffee. Black decor. Two separately controlled warmers. International electrical configurations available. I have a Kilowatt meter that tells you the electricity used. If the burners are not on it takes very little power to keep the tank warm. Amazing machine, quality made coffee maker. Pourover brewer requires no plumbing completely portable. Consistently brews perfect coffee. Stainless steel or black decor. Two separately controlled warmers. SplashGard funnel deflects hot liquids away from the hand. International electrical configurations available. Decanters not included.This may result in an extra shipping cost or refund in shipping cost if the final freight differs significantly from the cost estimate given initially by our website. See Shipping Notes. Requires 12 cup filters. Whether your roasted coffee is smooth and balanced or bold and fullerbodied, your brewed cup is fresh every time. These bags are 5.2 mil thick and have side gussets so they stand upright on store shelves. An interior foil barrier protects against oxygen and moisture to extend product freshness. Bags can be closed with a standard heat sealer, resealable tape, or with double wire adhesive tin ties.Plus guaranteed best prices. Contact the manufacturer directly to receive a quote. Industry's best technical support.

<http://gestibrok.com/images/bosu-ball-manual.pdf>



Get assistance from the most experienced 24 Oct 2013 To ensure you have the latest revision of the Operating Manual, Illustrated Parts Catalog, Programming Manual, or Service Manual, please visit the BunnOMatic website, at [www.bunn.com](http://www.bunn.com). This is absolutely FREE, and the quickest way to obtain the latest catalog and manual updates. Find owners guides and pdf support documentation for blenders, coffee makers, juicers and more. To ensure you have the latest revision of the Operating Manual, Illustrated Parts Catalog, Programming Manual, or Service Manual, please visit the BunnOMatic website, at [www.bunn.com](http://www.bunn.com). This is absolutely FREE, and the quickest way to obtain the latest catalog and manual updates. VP17 Coffee Maker pdf manual download. Examination reveals acute right serous otitis media with slight perforation of the central ICD10CM 2017 Coding Guidelines Update Details Gillian Long MMGS' The Code September, 2016 Issue 09 released the ICD10CM Official Coding Guidelines for coding Quizlet provides icd 10 cm guidelines activities, flashcards and games. Start learning today for free. Overseen by AHIMA using this guideline in ICD10CM is coding Diabetes Mellitus with associated The ICD10CM Official Guidelines for Coding and Get discount and special offers on 2017 ICD10CM Code Book. The following conventions are used to indicate and classify precautions in this manual. Always heed the information provided with them. Failure to heed precautions This manual describes programming of the CQM1, CPM1, CPM1A, and SRM1 Programmable Controllers, including memory structure, memory contents, ladderdiagram instructions, etc., and includes the sections described below. Refer to the CQM1 Operation Manual, CPM1 Operation Manual. CPM1A Operation Manual 3 Nov 1997 Notice OMRON products are manufactured for use according to proper procedures by a qualified operator and only for the purposes described in this manual.

The following conventions are used to indicate and classify precautions in this manual. OPERATION MANUAL. CPM1A Programmable Controllers Operation Manual Revised October 2007. iv. Notice OMRON products are manufactured for use according to proper procedures by a qualified operator and only for the purposes described in this EEPROM 256 kbits. Used with the Expansion Memory Unit. Programming Manual is referred to as simply the Programming Manual in this manual. This manual describes the system configuration and installation of the CPM2A and provides a basic explanation of operating procedures for the Programming Consoles. Please refer to the CPM1A manuals for the required information. The Smallest PLC in the SYSMAC Family Shows. Just How Far Downsizing Can Go. The 10point CPU is approximately the size of a PC Card. The SYSMAC C Series began developing a wide range of Programmable Controllers to meet factory automation Uploads and downloads program and setup memory areas to and from the controller. CPM1EMU01V1. EEPROM 256 kbits. Used with the Expansion Memory Unit. EEPROMCPM1EMU01. J MANUALS. Product. Description. Part number. Operation manual. CPM1A

programmable controllers operation manual. W317. Compact PLC series Ultracompact and Economical For a Wide Range of Uses AC or DC power, relay or transistor outputs, sourcing or sinking, etc. Check your specific New Mexico CDL Information for details. DMV consult the MVD's CDL Manual. Well now, let's seek for the other nm cdl manual book PDF if you have got this book review. You may find it on the search column that we provide. You may find it on the search column that we provide. Get ready for the 2018 New Mexico Commercial Driver's License test with these free practice tests that are scored instantly online. External Links. Spanish.

<http://oneself.pro/wp-content/plugins/formcraft/file-upload/server/content/files/1626d6e1bcd1b8---3hp-gamefisher-manual.pdf>

Video Lesson Spanish adjectives from BV1 Ch1 Ser PDF Worksheet Possessive Adjectives Video lesson Browse possessive adjectives in spanish resources on Teachers Pay Teachers, a marketplace trusted by millions of teachers for original educational resources. ACTIVITY SUGGESTION Before giving this worksheet to your students, review and discuss the different possessive adjectives. Spanish Possessive Adjectives. Once you find your worksheet, just click on the Open in new Two worksheets to practice Spanish possessive adjectives. Spanish I Possessive Adjectives Worksheets. Spanish Possessive Pronouns. Once you find your worksheet, just click on the Open in new Possessive adjectives describe things that belong to people. This lesson will guide your understanding of these adjectives and how they work with. And because it is a pourover model, it also does not require any sort of plumbing connection. This means it can be plugged in and used right away. It is a highly portable model, too, making this a good pourover coffee maker for many unique settings or purposes, including food trucks or farmer's markets. Reinsert the basket and fill a decanter with water, pouring it into the easytouse port at the top of the machine. Then, place the pot beneath the specially designed basket and filter, and click the brew button to begin making perfectly brewed coffee every time. NonDefective Returns Bunn accepts returns within a 60 day period if the product is returned in the original carton and in saleable condition. A 15% restocking fee will be applied to products that are not under warranty or defective. It is very important that machines are packed with original internal packaging and external carton to prevent damage during shipment. Please make sure to drain any remaining water inside of the unit prior to shipment. If you do not have the original materials, please call 1.800.637.8606 ext. 7273 to request them. For more information, go to [www.P65Warningsca.gov](http://www.P65Warningsca.gov) All rights reserved.

You must have JavaScript enabled in your browser to utilize the functionality of this website. For more information on what data is contained in the cookies, please see our. You can be assured that you will have fast shipping to anywhere in Canada. We recognize that restaurant owners do not have time to worry about their delivery followups. Our customer service is excellent and professional. We promise on all of our deliveries to be quick and worry free. Can you imagine the effect on your customers. Make sure your equipment is doing its job; come see us at Vortex and put your concerns to rest. Our variety of configurations and options can be designed to best suit your commercial kitchen layout and your budget. You cannot risk such a catastrophe. Choose the proper commercial dishwashing equipment and supplies, and you and your staff will be able to clean up your dishes in a quick and effective manner. It is imperative to have clean and sanitized tableware for your customers. With pots, pans, inserts, and all your kitchen accessories, your workspace can become crowded very quickly. The proper storage of all items is done most efficiently by our selection of Storage and Stainless shelving, chrome or epoxy racks and of course, no kitchen is complete without the versatile work table. All food service businesses need to keep their food properly stored, separated, and ready for easy transport. Whether you need baking supplies, pizza pans and bags, bartending supplies, or food storage inserts, see us at Vortex Restaurant Equipment for those ohsoimportant kitchen pieces. We know your time is valuable so base on your business type, you can choose the latest and greatest variety of Restaurant Supplies to keep your customers happy and your

employees working efficiently. ULC has tested products for public safety for 90 years. Your rating  
Competitive prices, fast shipping across Canada. Understanding and responding to customer  
requirements has always been important to the.

Today, BUNN is a global partner you can count on Since 1957, BUNN has been at the forefront of  
beverage equipment innovation inventing the As customers entered the digital age. BUNN also  
embraced sophisticated new technology to meet changing needs. Today, we offer a complete  
product line of dispensed beverage equipment including coffee Each product launch is driven by an  
ongoing commitment to delivering the highest possible With thousands of loyal commercial and  
home The global headquarters are located in Springfield, Illinois, USA, where the company strives  
for Kingdom, Germany, China, Hong Kong, and Brazil. Brewers and Urns Brewers Volume  
Systems Brewers Water Dispensers Brewers Systems Systems. Servers. 21, 25, 26, 33. Decanters and  
Warmers. 66. Universal Airpot Racks. 67. Stock Funnels. 68. Special Purpose Funnels. 69. Drip  
Trays. 6971 International models available. Detailed descriptions are Please refer to the installation  
manual. Electrical Testing. Labs Sanitation. Electrical Testing. Labs Canada. Labs Safety. NSF  
International. Canadian Safety. UL Classified. Public Health Low Profile Multi Beverage Tea and Coffee  
Brewer H5E Element Oatmeal Ab. Ab Brew Station and 1 Rack Assembly Rack Assembly Model Volts.  
Amps. HxWxD. Attached Yes Agencies Brew. Station Header. Rack. Assembly Yes Techenabled,  
baristacrafted single cup brewer that heightens the quality of coffee and tea. Every coffee has a  
voice. With the trifacta, the barista creates an experience which unlocks the nuances See trifacta  
grinder on page 38. Visit [www.trifactaexperience.com](http://www.trifactaexperience.com) for more information. Volts.  
Attached Yes Agencies An integral part of any office coffee service program Model Weight.  
Finishes Stainless Brewing. Capacity Amps. Black. Stainless Volts Black Attached. Agencies An integral  
part of any office coffee service program. Decanters sold separately, see page 66. HxWxD.  
VPS Black Volts. Watts Cord. Attached Agencies An integral part of any office coffee service  
program Servers sold separately, see pages 21. Model Weight Volts. Funnel. Type.

Attached Plastic. Yes. Agencies Thermal Server Coffee Brewers. Brew directly into portable,  
vacuum insulated servers that keep coffee at optimal flavor for hours Model Weight Volts. Attached.  
Agencies. Plastic Funnel. Plastic Decanters sold separately, see page 66. Volts. Attached Plastic Yes.  
Agencies Dual voltage available. Can operate at. Decanters sold separately, see page 66. Ab.  
Capacity Cord. No Weight Yes Funnel. Type Plastic. No. Yes Medium volume brewing solution with  
simple switch controls. Model Brewing. Watts Type. HxWxD Plastic Stainless Plastic. Stainless. Plastic.  
Weight Agencies. Yes Stainless. No Medium volume brewing solution with simple switch  
controls Model Volts Capacity Weight Attached Yes. Yes Plastic. No Stainless. Agencies Plastic.  
Stainless Type Yes AXIOM Twin. Coffee Brewers Ab. Model Amps. Watts Brewing. Weight Model.  
Capacity Weight. Attached No Agencies Yes No Yes Decanters sold separately, see page 66.  
Model Weight. Attached Agencies Stainless Plastic Stainless Volts. Amps Capacity. HxWxD Weight.  
Agencies No Spacesaving brewer yields a variety of flavor profiles with Digital Brewer Control and  
precise Ab. Ab Ab Model ICB Twin. ICB Twin Amps. Capacity Type. Weight Smart. Yes Agencies ICB Twin  
Tall. Spacesaving brewer yields a variety of flavor profiles with Digital Brewer Control and  
precise Ab. Ab Display capable of showing English or Metric measurements. Ab Model. ICB DV  
Tall Amps. Smart. Weight Cord. Agencies Medium volume brewing solution featuring Digital Brewer  
Control, precise extraction control Ab. Ab Model Amps. Funnel Cord. Stainless Agencies WAVE 15 SAPS  
Silver. Low profile brewer featuring Smart WAVE technology, Digital Brewer Control, Ab. Ab No.  
20115.0000. Gourmet Utilizing thermal No. 20115.0000. Airpots and thermal carafes  
sold Plastic Weight. Type Utilizing thermal Model Volts. Attached Black. Agencies Airpot Brewers Low  
profile brewer with simple switch controls and flexible server options Model. Amps Brewing.  
Capacity Steel Funnel Funnel. No Steel. Agencies Gourmet. Funnel Attached Pourover Weight No. Steel.  
Gourmet.

FunnelThermal Carafe Coffee BrewersAbModelAmps. HxWxDCord. AgenciesYes. Black  
PlasticAirpot. LeverAction. Airpot. Vacuum. Pitcher. Thermal. Carafe.

<http://schlammatlas.de/en/node/15616>