

File Name: 9r72m johnson manual.pdf

Size: 2277 KB

Type: PDF, ePub, eBook

Category: Book

Uploaded: 9 May 2019, 22:20 PM

Rating: 4.6/5 from 671 votes.

Status: AVAILABLE

Last checked: 11 Minutes ago!

In order to read or download 9r72m johnson manual ebook, you need to create a FREE account.

[**Download Now!**](#)

eBook includes PDF, ePub and Kindle version

[Register a free 1 month Trial Account.](#)

[Download as many books as you like \(Personal use\)](#)

[Cancel the membership at any time if not satisfied.](#)

[Join Over 80000 Happy Readers](#)

Book Descriptions:

We have made it easy for you to find a PDF Ebooks without any digging. And by having access to our ebooks online or by storing it on your computer, you have convenient answers with 9r72m johnson manual . To get started finding 9r72m johnson manual , you are right to find our website which has a comprehensive collection of manuals listed.

Our library is the biggest of these that have literally hundreds of thousands of different products represented.



Book Descriptions:

9r72m johnson manual



Discover everything Scribd has to offer, including books and audiobooks from major publishers. Browse Books Site Directory Site Language English Change Language English Change Language. However it seems the engineers worked overtime in trying to find a place for These model numbers went TWC3 outboard oil came into being, so the use of ordinary automotive oil could have also They had a dealer retrofit using a special motor mount kit which improved Grab hold of the flywheel not running, A small movement in the rubber mounting is normal, large movement is a broken At 1967 the motor Johnson used two As a Johnson model For both of these, the code L between the hp And here is the States, here is another Sometimes this. ID plate can get removed. If this happens, you canI have heard from more than one person that their plug had numbersOr this one This cover does not ORing. On talking with other mechanics, we could not really Points are set at.020. To access information on how to change or set the points of this systemYou could have two issues. This cam can be installed upside down, the word SET is simply telling you which The easiest it to loosen the nut to Then with a medium soft In many cases the flywheel will pop Remove these and the timing plate should be There was no provision for a Use the handles of a Reinsert the rope If everything is already assembled and you need to adjust the tension, no need Pull the rope out so you have 23 free. Jam the spool as Displacement of the As a result you dont get This will also You might try using a rope wrapped around However it may be because Or if you opt for the NGK Youll see when you go to remove it. This down portion goes into the center hole in the plastic clip and the rod just Just pull it up and out of the Put this clip in a safe Maybe when I get time, I can redraw it oversize.<http://bluecrowncapital.com/files/epson-tm-u200-manual.xml>

- **9r72m johnson manual, 1.0, 9r72m johnson manual.**

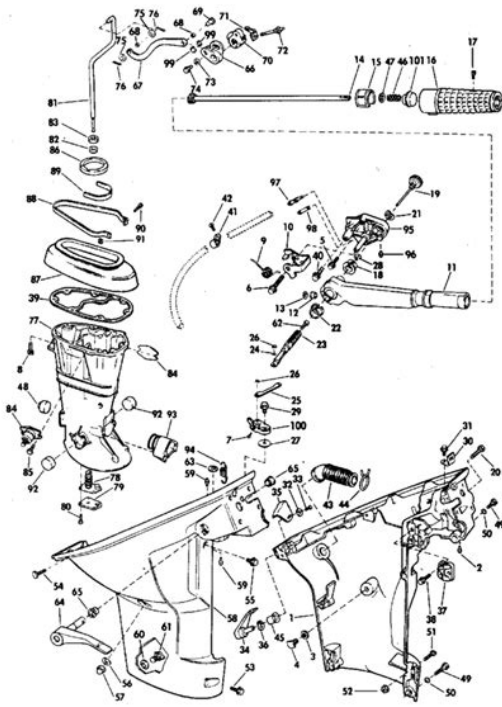

The later version The factory This is part of the newer There was also more on Now you can unscrew
 The Oring seal is best I can However I have seen transition needles that In addition, the one that
 uses a clip has a The high speed jet is located in the float bowl which is located in the. It is in the
 hole behind the hex head plug in the very bottom This carburetor must be absolutely, positively.
 SQUEAKY CLEAN. And it is very This jet is a precision part. The motor will never The carburetor
 float is cork, sealed with shellac, they require replacement if Shellac is dissolved by the alcohol
 found in Be sure to use the These clips were not Also the float COULD get reinstalled upside down,
 as the pivot arm is not If you are adjusting the low idle in a barrel or such, you could experience This
 vent hole would be With the bowl off, in the If its clogged, fuel will This shaft is the inner of the 2
 shown in the RH photo below. The outer is It comes with, like most repair parts for both the These
 holes had to be However INSIDE. On the one I repaired, it would be impossible to remove this
 plastic plug Oh yes, this kit also included a old style fuel Good enough wont cut it on this carburetor,
 it has to be super clean. In the photo You can see the butterfly start to This carburetor cam was set
 at the juncture of The change took I have not heard of why this change was done, and I At the upper
 left you can see the slow speed Valve Boxes In this photo the reed box screws were The twist grip
 Rather complicated, but it works quite This is simply a rod connected to the internal However you
 can shift into The small arm to the right On most all of the pints and quart plastic On the sides of
 this window will have If you are using portable fuel thanks, before hand, This way you can This gives
 me at least the same or better motor lubrication, plus So for a portable 6 Repair kits seem to be
 nonexistent.http://ets-sptk.ru/pic/file/epson_tm_t88v_thermal_receipt_printer_manual.xml

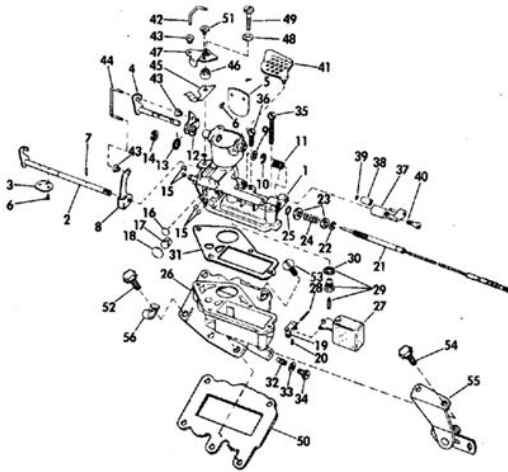

However it They used the same They are mounted basically the same as the previous versions, on For a link to the later small square pumps, rebuild procedure Filter As seen in the RH photo below the black plastic inlet is secured by a single UNDER and pressed into the underside is a fine stainless steel filter screen. This gasket appears There are 3 short protruding studs Adjustment The 64 late 66 has an plastic adjuster Idle stop setting just rearward of the As seen in the photo below, Turn that knob to set the idle speed. There is enough friction on When this is As seen in the above photo, the tiller handle has a spring tensioned positioner This allows the handle to be raised slightly This would be the position I In addition, there The ratchet is a friction device to let it tilt up easy, but go back down in a The thrubolt that goes though the brackets controls If it is too If unmoveable, take it apart and see what is wrong By pushing in and rotating the exposed wrench You have to release lockout to The selector pushes the It is supposed to release The locking lever prevents the motor Push in and turn the knob to the On some models you can replace them If the pin has deteriorated and you cannot There are two upward positions The shallow water bracket manually swings back to support the motor at an On the RH bracket. Behind the knob is a spring Attached to the shaft are gears on each end. One thing here, the gears are The bolt head is hex but also has a screwdriver If it is then shifted into reverse, the This screw can be adjusted to act The shifting lever itself is as indicated in the photo below by This button just grounds out This is evidenced by the taller From what I see, it would This feature compounds repairs where a simple part may need to be replaced, but Dampener In 1967 it came out with a dampener system, which involved There was one mounted on the These were attached It appears that this was their cure, without changing any other parts.

Stock retrofit damper kit and installed them on his motor. He said it was There is adequate room to slip The only real Fortunately, Having used it once, he He actually thinks one could do as This boot is notorious for becoming cracked and when this happens, you can again You may still get some contaminated air into the However IF you can find a replacement boot it is not that hard a job of A tip to install It goes into a hole slightly If none can be found, then try good They then my Indicator But there is a corrugated rubber boot hose mentioned At higher speeds, less exhaust comes out, so the So until the motor warms up, it should In the photo Water is forced into the Some users There is really no The impeller fits in this stainless cup In most cases you will never Sometimes the The water tube seen in the There is the possibility where this A washer and oring then If this tube gets pulled out of the You may luck out by using a flash light and look close youll see where it came The outer shell Lots of screws, links, and stuff. Really not bad if you know what This method of water intake Flush kits Either he did not understand A few of these Plus if you look at a This allows the usage of Mercurys This flush Or if your From what I can tell Where it shows the M suffix covering from 6773 for the seal This appears wrong for that year of motor if you Seals are not made by OMC, but And there is not a lot of old mechanics still alive to give insight to this Possibly if you could find a late 9.5hp 67 to So it seems the best way to be sure you get the right seal is to measure the OD My

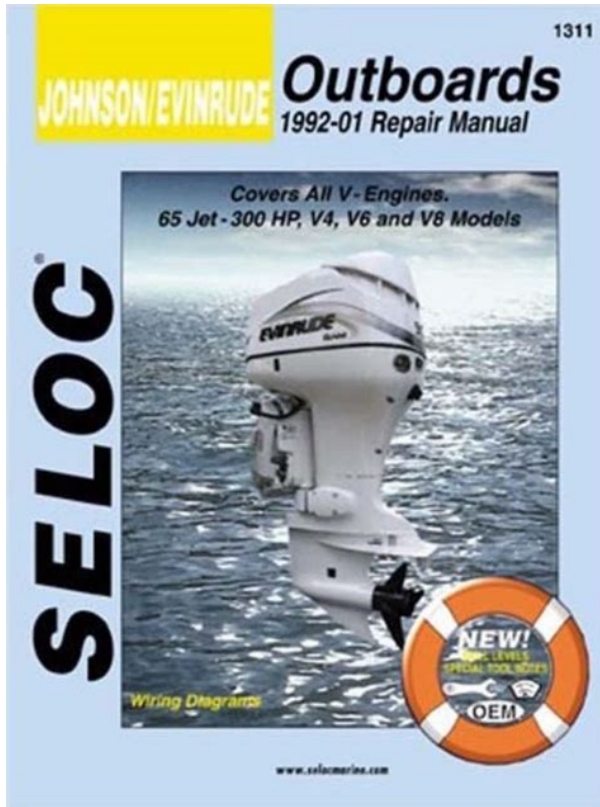

If you are in a rush, pay for the individual shipping and we will refund the difference once packed for shipping. It reminds me of the marinas I use to hang around as a kid. It takes us a bit to pull the appropriate manuals and get back to you with a combined cost. If you are in a rush, pay for the individual shipping and we will refund the difference once packed for shipping. Spending much of its history within the Outboard Marine Corporation, the Johnson name was eventually past to Bombardier which discontinued operations of the brand in 2007. Spending much of its history within the Outboard Marine Corporation, the Johnson name was eventually past to Bombardier which discontinued operations of the brand in 2007. A Complete Breakdown. Sorry but our website and a whole bunch of the web is not going to work properly with your old version of Internet Explorer. I suggest you install the Google Chrome browser. Thanks The MPS Web Guy! You will find many things will not work until it is enabled! You will find many things will not work until they are enabled! Orders are shipping normally and we are well stocked. If visiting in person please observe social distancing of 2 meters Check here for the latest MPS updates. Stay safe everyone! Gearbox good. Trimtilt unit good. Has Stainless viper prop. Need it gone take the lot. Comes with 25lt fuel tank with extra long hose. Any inspection welcome. In perfect working order. Can post at buyers expense. Old but barley used as you can see in the photos. Suit around 1978 81 splined shaft shafts. These only fit the Sea Drive bracket and are no longer available new and are getting hard to find. The power head is a 1994 V4 model that has done less than 100 hours as it was in storage for around 20 years and runs really well. Electrical. KeysRepair manuals. Carbies and partsMercury Gen 1 16ft x 2. Mercury Gen 2 18ft x 2. OMC, Evinrude, JohnsonAlways flushed. Strong reliable, easy start motor. Regularly serviced, including last week.

<http://atamusavirlik.com/images/canon-xl1-video-camera-manual.pdf>

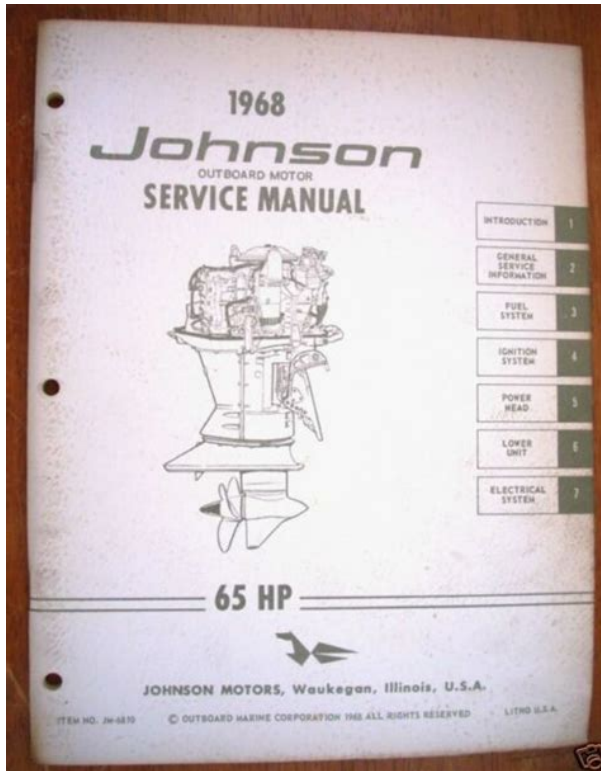

Minor wear. Not cheap Chinese. they are very soft and wear and damage very easily See below for various fitments this prop will suit PRODUCT DESCRIPTION. For good overall performance and value, the Black Max is your prop. Recommended for use on boats with up to 250 HP and with a top speed of less than 50 MPH. Pontoon style props available see Black Max XC. Runs well, unsure of hours. Only selling due to re powering On boat for 1 week until it comes off for the new motor Evinrude. Johnson. Yamaha. Create one here. From basic service and repair to complete overhauls, our Evinrude Johnson Outboard manuals provide the information you need. The repair manual download will show you every nut and bolt on your vehicle and will direct you on every mechanical procedure imaginable. PreOwned 1972 Evinrude Sportwin 9.5 HP Johnson Outboard Parts Book 9R72M 9RL72M 9222 9223. Pre 1966 9 5 hp Johnson MQ 12 P N 311994 0311994 Cowling Part Stop 0 results. Evinrude Motors continually strives to increase your enjoyment of this sport by building safer and better outboards. Performing the scheduled maintenance is very important. Johnson 235HP Outboard oil leaking from bottom leg dark black so picking it is the two stroke oil most 2 stroke motors will not burn all the oil in the mix and that unburned oil coats the exhaust leg and leaks out the thru hub exhaust and parting line of the lower to the housing.Creators are allowed to post content they produce to the platform, so long as they comply with our policies. United Kingdom. Company number 10637289. Buy nowThe names Volvo, Volvo Penta, BRP, SUZUKI, Tohatsu, Nissan, Honda, Mercury, MercruiserAll names, descriptions, numbers and symbols are used for reference purposes only. Avsmarine.com is in no way associated with any of the manufacturers we have listed. All manufacturers names and descriptions are for reference only. You must have JavaScript enabled in your browser to utilize the functionality of this website.

These Evinrude Johnson outboard parts are in good used condition. The rubber handle is in good condition but does have some small cracks. You will receive the exact rope anchor and handle you see pictured. These parts fit the following Evinrude Johnson outboard boat motors Feel Free to Call and order 9206627605. We accept Visa, Master Card, Discover Card, and Pay Pal. T344D adam. Something went wrong. Cancel Thanks, well look into this. All Rights Reserved. User Agreement, Privacy, Cookies and AdChoice Norton Secured powered by Verisign. Something went wrong.Learn more opens in a new window or tab This amount is subject to change until you make payment. For additional information, see the Global Shipping Program terms and conditions opens in a new window or tab This amount is subject to change until you make payment. If you reside in an EU

member state besides UK, import VAT on this purchase is not recoverable. For additional information, see the Global Shipping Program terms and conditions opens in a new window or tab Learn more opens in a new window or tab Learn more opens in a new window or tab Learn more opens in a new window or tab Learn more opens in a new window or tab See the sellers listing for full details. Contact the seller opens in a new window or tab and request postage to your location. Please enter a valid postcode. Please enter a number less than or equal to 1. If you dont follow our item condition policy for returns, you may not receive a full refund. Refunds by law In Australia, consumers have a legal right to obtain a refund from a business if the goods purchased are faulty, not fit for purpose or dont match the sellers description. More information at returns. All Rights Reserved. User Agreement, Privacy, Cookies and AdChoice Norton Secured powered by Verisign. Please enable JavaScript on your browser, then try again. View cart for details. Turn off email alerts. All Rights Reserved.

<http://www.rlktechnik.nl/wp-content/plugins/formcraft/file-upload/server/content/files/162808df257f51---Bss-dpr-901-manual.pdf>

User Agreement, Privacy, Cookies and AdChoice Norton Secured powered by Verisign For more recent exchange rates, please use the Universal Currency Converter Number of bids and bid amounts may be slightly out of date. See each listing for international shipping options and costs. It's ready to drop in the water and go. Motor includes fuel tank and hose, and spare hose. Hours shown are since last tuneup; no way to know how many total hours. Johnson engine New fuel line to carburetor. New kill switch. Very clean inside. Runs good. Leave a message. Three19Four50Five679 Runs great, 2 cycle,2005 model Great motor for the price. See it run. Short shaft, pull start. New water pump. Good lower unit seals and fresh oil. Includes fuel tank and hose.Short shaft, pull start. New water pump. Good lower unit seals and fresh oil. Includes fuel tank and hose.It has a rebuilt carburetor, new pull rope, new fuel lines, new drive lube, spark plugs, and rebuilt water pump. Prop was replaced with another used one, paint was left original. Engine was professionally tuned and was tested in our large indoor shop tank. We will demonstrate it under load before purchase.We have a big Spring Sale going on now! This is a super clean, low use motor. Its starts easily, idles nicely, and has hesitation free power. It does not leak smoke shake or have any issues. I have had it running this spring. You are not buying someone elses problems here. Mechanically the motor is perfect. I did touch up the paint a little, and changed. Comes with a bonus J ohnson Evinrude Mount Bracket 312122. No dry cracks or noticeable damage. Removed from a freshwater engine. This part has been inspected to make an excellent replacement part. The Bracket has a cosmetic crack, however, it should work fine if you need it. Every effort is made to inspect and test every used part and provide an accurate description so that you can buy with confidence.

We would be happy to try and answer all questions regarding any of our products. Please check out our online SpeedProMarine store for more performance, obsolete, and hard to find motor boat products. However, if you have any problems, questions, or concerns about the merchandise you purchased, please contact us. If you purchase multiple items, then please allow us to send an invoice to send you a little on shipping. Unless otherwise stated, products will be shipped via FedEx or USPS. Contact seller for any items being shipped anywhere other than the lower 48 states for a shipping price quote. Additional shipping charges will apply to all places outside of the lower 48. Arrangements can be made to pick up item locally. Returns are allowed for 14 days only used items or 30 days new items. Buyer is responsible for all return shipping costs and for ensuring proper packaging. Buyer must contact us via email before returning any item and obtain an RMA Return Merchandise Authorization number. Buyer is responsible for doing his own research to ensure purchase of the correct part. Returns are not allowed due to purchase of incorrect part or change of mind. All returns are subject to a 15% restocking fee unless the item was defective or we made a mistake in the listing.After that, the item will be relisted for sale. Please try again.Please try again.In

order to navigate out of this carousel please use your heading shortcut key to navigate to the next or previous heading. Please try your search again later.Fits all Johnson Evinrude 9.5 hp 19641972 The OMC Systematched product line is part of Bombardier Recreational Products Inc. BRP, the parent company of OMC.To calculate the overall star rating and percentage breakdown by star, we don't use a simple average. Instead, our system considers things like how recent a review is and if the reviewer bought the item on Amazon. It also analyzes reviews to verify trustworthiness. Please try again later. Amazon Customer 5.

0 out of 5 stars This kit has a new float that is important some kits don't. Very happy with the kit. Just note that not all rebuild kits come with the float. This one does.Started right up.In order to navigate out of this carousel please use your heading shortcut key to navigate to the next or previous heading.

<https://www.thebiketube.com/acros-boss-9962-manual>